

- EXTREME MOBILITY EVEN IN LIMITED SPACES AND DIFFICULT CONSTRUCTION SITES
- TOTAL CONTROL AND MAXIMUM SAFETY
- RELIABILITY AND VERSATILITY
- EXTREME MANEUVERABILITY AND SPEED OF WORK
- SIMPLE TO USE



Speedcast makes any maneuver easy even in tight and difficult to reach spaces



**EASY TO TRANSPORT**



**BY ROAD**  
WITH LOWERED TRAILER



**BY SEA**  
OPEN TOP 40' CONTAINER WITH A MINIMUM HEIGHT OF 9' 4"

*With hopper and tires removed*

MOTORIZED CARRIAGE		
All wheel drive	/	4x4
All wheel steering wheels	N°	4
Front and rear lights complete with direction indicators		
TIRES		
385/65 R22.5 type	ø ft	3' 7"
Tread suitable for rough terrain		
Tires filled with high density polyurethane foam		
ENGINE (stage V - final tier IV)		
Yanmar diesel engine (TC)	N°	4 cylinders
Power	HP	72
Displacement	in <sup>3</sup>	202
CONCRETE HOPPER		
Vibrated capacity	yd <sup>3</sup>	4
Fresh concrete	yd <sup>3</sup>	5.3
Rotation	°	± 90
Maximum incline	°	18
Presence of upper containment flanges in inclined position		
EXTRACTION SCREW CONVEYOR		
Discharge capacity	yd <sup>3</sup> /h	78.5
Diameter	ft	1' 1"
Trough coating in Hardox 400	ft	1' 8"
Helical blade in Hardox		
TANKS		
Diesel fuel	gals	30.4
Hydraulic oil	gals	21.1
WEIGHTS		
Machine weight	lbs	21,830

**SPEEDCAST 5.0**

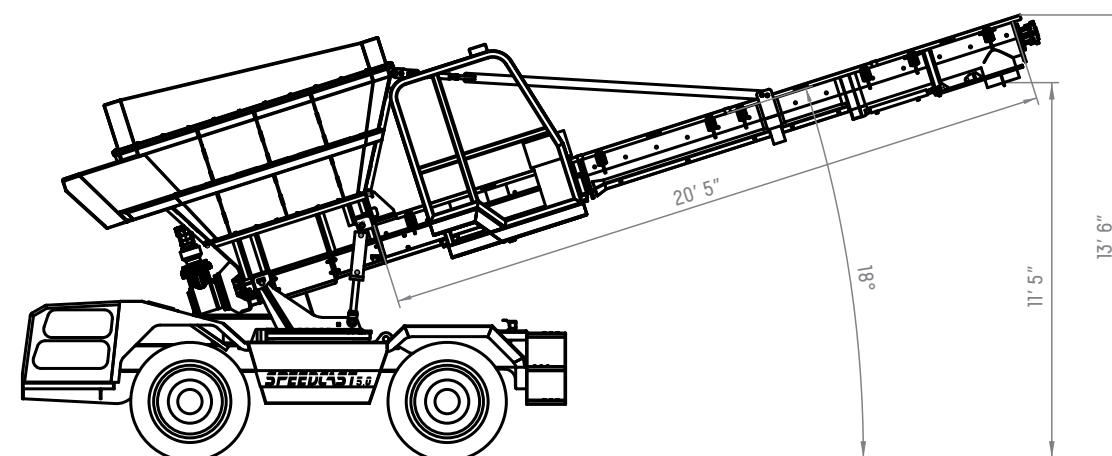
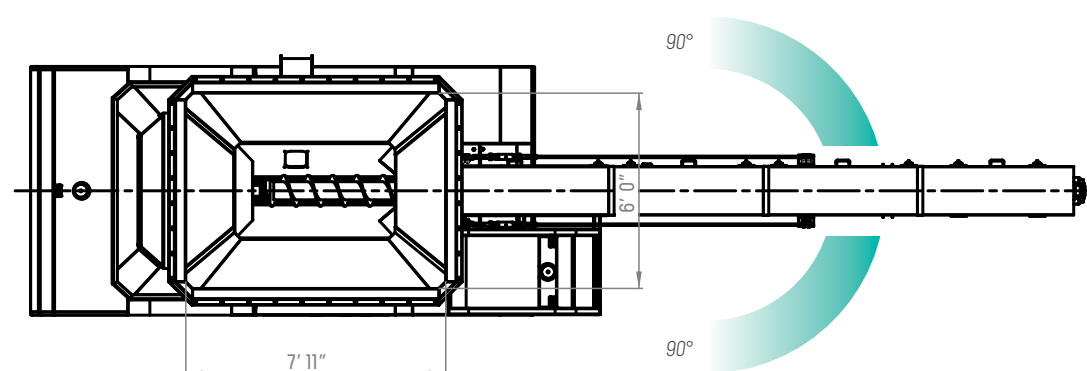
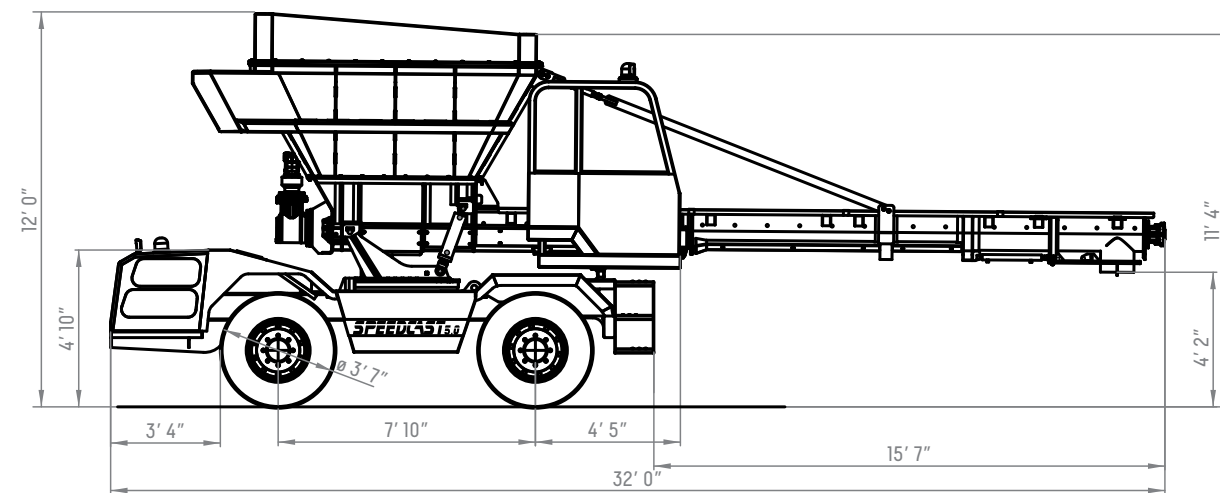

**ULTR HIGH PERFORMANCE & ADHERES TO ALL RULES AND REGULATIONS**

**SPEEDCAST 5.0**



SPEEDCAST is a mobile operating machine on wheels for transporting and laying of concrete and cement aggregates in forms and casting molds (S2-S3-S4 and beyond up to SCC class).

• Extreme versatility. SPEEDCAST can be used in many different situations, ensuring a high return on investment. 180° Rotation [90° clockwise - 90° counter-clockwise ]

• Exceptional maneuverability and power thanks to four-wheel drive (4x4) - four drive wheels with rear axle steering direction equal or opposite to front axle.

SPEEDCAST 5.0 meets the needs of a particular sector of traditional precast concrete distribution systems. Distribution usually takes place through overhead systems with special modular lines fed by stationary or mobile concrete pumps or through other systems.

SPEEDCAST represents a more versatile and efficient solution for the distribution of concrete within precast plants.

- Extremely low operating costs, due to easy and simple maintenance which saves both time and money.
- Costs reduced to a minimum by using a single operator to manage transport and casting, allowing for greater profit margins.
- Excellent efficiency due to great control for high maneuvering speed and casting precision.



Maximum maneuverability thanks to active steering on all four drive wheels



SPEEDCAST makes filling horizontal precast formwork easy with SCC

